

## CODING INSTRUCTIONS FOR CAME TOP 312NA/312EE/432NA/432EV/432EE REMOTES

01	Have existing working remote and new remote to be programmed available.
02	Remove new CAME (models mentioned above) remote from packaging.
03	With the new CAME (models mentioned above) remotes press both of the buttons together until the LED light flashes more quickly. (approx 10 seconds)
04	Then press the first button to code. The red LED stops flashing and remains lit continuously. Release the button
05	Within ten seconds bring the old remote to the back of the new remote.
06	Press the button on the old remote, which is one you wish to teach to the new remote.
07	While continuously pressing the button on the old remote, slide the old remote underneath the length of the new remote. (see figure)
08	The new remote LED will flash three times to indicate it has learnt the new code.
09	Release button on the old remote.
10	Test the new remote activation.
11	Repeat procedure to code the other button.

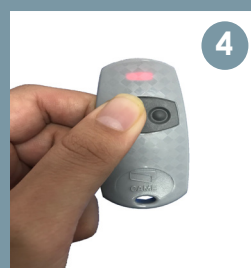
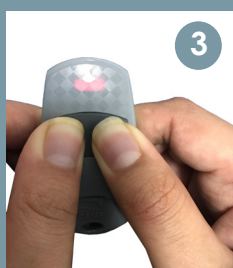

## CODING INSTRUCTIONS FOR CAME 314MA/434NA TRANSMITTERS

01	Have both old and new remote available.
02	Remove new CAME (models mentioned above) remote from packaging.
03	With the new CAME (models mentioned above) remote press the button you want to program and hold it until the LED stops flashing and remains lit continuously. (approx 10 seconds)
04	Within ten seconds bring the old remote to the back of the remote.
05	Press the button on the old remote, which is one you wish to teach to the new remote.
06	While continuously pressing the button on the old remote, slide the old remote underneath the length of the new remote. (see figure)
07	The new remote LED will flash three times to indicate it has learnt the new code.
08	Release button on the old remote.
09	Test the new remote activation.
10	Repeat procedure to code the other button.



P: +64 7 849 4941  
E: [info@adg.co.nz](mailto:info@adg.co.nz)

F: +64 7 849 4907  
W: [www.adg.co.nz](http://www.adg.co.nz)

36 - 40 Mahana Road, Te Rapa,  
Hamilton, New Zealand 3200